

L I Z





LIZ, WHERE FREEDOM IS QUEEN. Le Groupe Maurice is known for carefully selecting where it situates its residences. A genuine architectural jewel, the 10-storey building will blend in superbly with the warm and flourishing environment of this district, known for its cachet and prestige. Easily accessible by bus, metro or commuter train, the residence is also close to major roadways, including the Decarie Expressway and Sherbrooke Street. Numerous parks, businesses, clinics and hospitals are also nearby. For a delightful and cozy retirement, you owe it to yourself to live at LIZ! ■



10

FLOORS

318

APARTMENTS

20

CARE
UNITS



CLOSE TO



SERVICES



GREEN SPACES



TRAIN COMMUTER



LIZ,
**LIVING THE LIFE
OF LUXURY.**

Located at the corner of Ste-Catherine Street West and de Maisonneuve Boulevard West, LIZ lets you enjoy your routine and those little pleasures in life, such as savouring a delicious pastry at the local bakery. You can also count among your daily activities, a visit to wonderful Westmount Park with its tennis courts, dog run, bike path, skating rinks, swimming pool and much more! ■

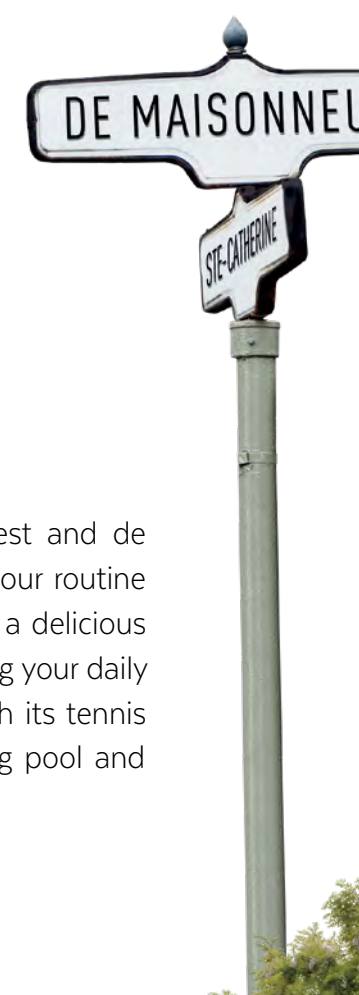

IN THE HEART OF IT ALL

Culture, public transport and accessibility to health services are among the many highlights of this area.





SPACIOUS LUMINOUS LUXURIOUS



REFINEMENT HAS A NAME:

LIZ

This majestic residential complex renders you access to large and lavish serviced apartments. Rental units range from 1½ room studios to 5½ room apartments. Generous windows bathe you in abundant light... while modern stainless steel appliances, durable quartz countertops and two-tone shaker-type kitchen cabinets let you welcome friends and loved ones in elegance and style! ■





A VERITABLE JEWEL



Main dining room



Common lounge with piano



Purposefully **MODERN**

LIZ residence will feature impressive common areas, including a superb panoramic lounge, ideal for both pleasure and relaxation – not to mention, many indispensable amenities so that you can take good care of yourself, both physically and spiritually. In short, everything you need to make your retirement a pleasant and rewarding experience, is always at your beck and call. ■



Billiards room



Panoramic lounge

FOR A RETIREMENT FILLED WITH VITALITY



Fireplace lounge



Reception



Library area



A FANTASTIC VIEW

The panoramic lounge affords you an impressive view of the northern part of the city and iconic Mount Royal.



Roof terrace, 4th floor



A FAVOURABLE NATURE

Le Groupe Maurice understands the intimate link between nature and health, which is why it pays particular attention to the landscaping of its residences. And LIZ will be no exception. Expect spaces that seduce you with lush gardens and comfortable terraces where nature is queen. The abundant picture windows will allow you, among other things, to witness the changing of the seasons in all their splendour and glory. ■

Roof terrace, 2nd floor



COMMON AREAS LOCATED ON 5 FLOORS

(Garden level, ground floor, 2nd floor, 4th floor, 10th floor)

A GROUND FLOOR

- | | |
|-----------------------------|-------------------------|
| 1. Reception | 6. Activity room |
| 2. Wine cellar | 7. Dining room (common) |
| 3. Common area (with piano) | 8. Art studio |
| 4. Kitchen | 9. Cinema |
| 5. Dining room (private) | 10. Pharmacy / bistro |
| | 11. Billiards room |
| | 12. Library area |

B 2nd FLOOR

13. Roof terrace

C 4TH FLOOR

14. Petanque / shuffleboard

D GARDEN LEVEL

15. Swimming pool, sauna and spa, indoor beach and light therapy
16. Training room
17. Hairdresser / beauty salon
18. Virtual Golf

E 10TH FLOOR

19. Panoramic lounge

OTHER:

- Administrative office
- Place of worship, 4th floor
- Elevators

LOCATION OF COMMON AREAS BY FLOOR

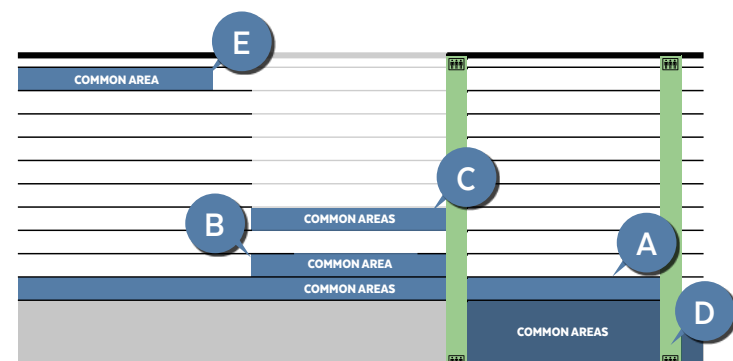

GROUND FLOOR



ALL THE LEISURE YOU LIKE *right at your doorstep!*

Your tastes, passions and talents define you; whether you express them through your activities, your hobbies or your personality. With its welcoming common living spaces, the LIZ residence was designed to satisfy the preferences and desires of Montrealers. Live your retirement to the fullest! ■

2ND FLOOR - B



4TH FLOOR - C

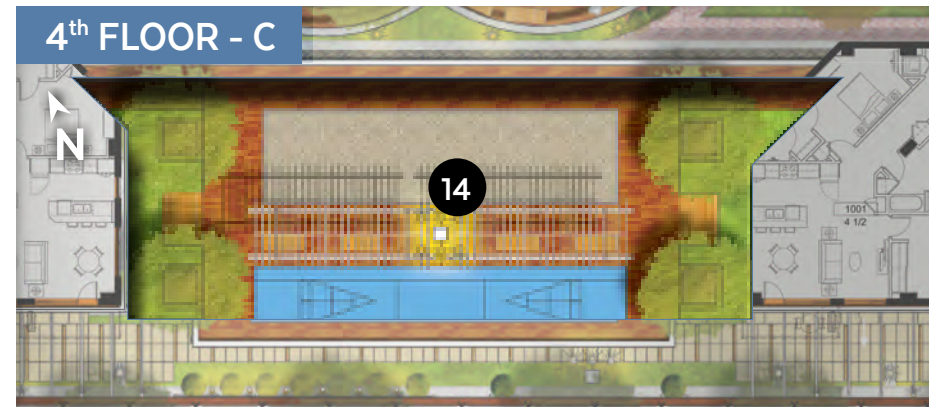

GARDEN LEVEL - D



10TH FLOOR - E

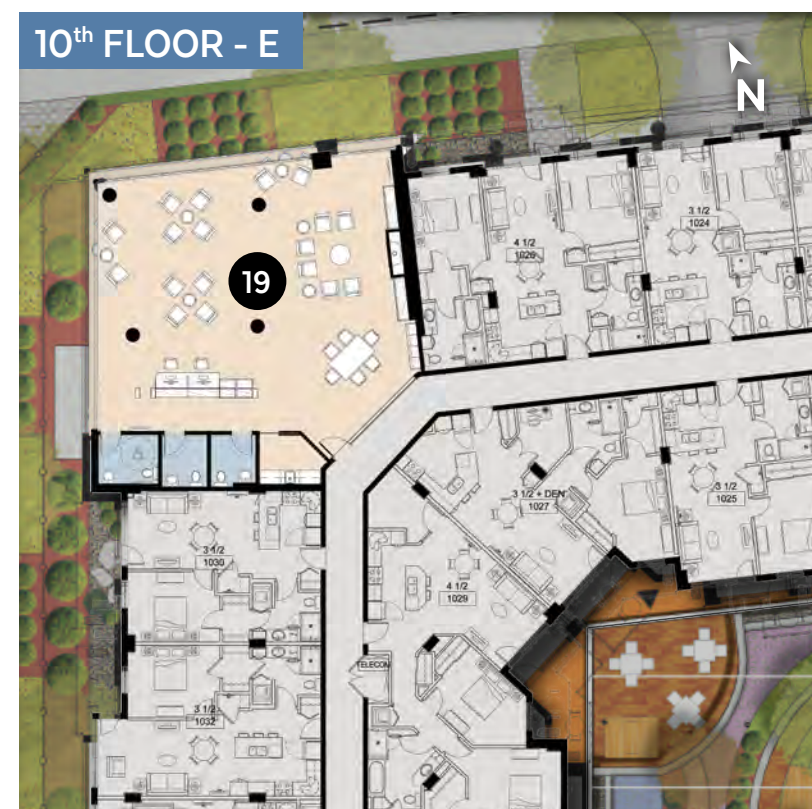



Short for Elisabeth, LIZ refers to the tenderness, poise and stature of this feminine name, associated worldwide with the Queen of England. The logo echoing her name, is simple and evocative, featuring symbols relating to royalty, with a modern touch. The image is in perfect synergy with the presence and poise of this much anticipated new residence of Le Groupe Maurice. ■

RENTAL OFFICE

5100 de Maisonneuve Blvd West
Local A1 H4A 3T2

MAILING ADDRESS

2400 rue des Nations, Suite 137
Saint-Laurent, Quebec H4R 3G4

PHONE: 514 380-9800
Fax: 514 380-9801
info@residenceliz.com
residenceliz.com



By using 850 lbs of Rolland Enviro Print with 100% recycled content, we reduced our environmental impact by:

- 2 metric tons of wood (10 trees)
- 3 m3 of global water (equal to 30, 10-minute showers in North America)
- 656 kg of CO2 (equalling 2,614 km travelled by car)
- 18 gigajoules (or 81,190 60W bulbs turned on for one hour)
- 4 kg of NMVOC emissions (equalling 3,226 km travelled by car)

AMBIANCE
Nun’s Island

L’AVANTAGE
Brossard

BORÉA
Blainville

CALÉO
Boucherville

LE CAVALIER
LaSalle

LA CITÉ DES TOURS
Saint-Jean-sur-Richelieu

LA CROISÉE DE L’EST
Granby

ELOGIA
Montreal

ÉKLA
Québec

LE FÉLIX
Vaudreuil-Dorion

FLORÉA
Terrebonne

LE GIBRALTAR
Quebec

L’IMAGE D’OUTREMONT
Outremont

L’INITIAL
Gatineau (Aylmer)

ivvi
Laval

LES JARDINS
DU CAMPANILE
Shawinigan

LES JARDINS MILLEN
Montreal

LE NOTRE-DAME
Repentigny

LE 22
Montreal

LES PROMENADES
DU PARC
Longueuil

LE QUARTIER
MONT-SAINT-HILAIRE
Mont-Saint-Hilaire

LILO
L’Île-Perrot

MARGO
Lévis

ORA
Montréal

QUARTIER SUD
Lévis

LES RÉSIDENCES
DU MARCHÉ
Sainte-Thérèse

LE SAVIGNON
Lachine

STATION EST
Montréal

SEVĀ
Candiac

VENT DE L’OUEST
Sainte-Geneviève

LES VERRIÈRES DU GOLF
Saint-Laurent

VAST
Sainte-Julie

VÜ
Sherbrooke

45NORD
Mascouche
Under construction

CORNELIUS
Montreal
Under construction

LIZ
Montreal
Under construction